

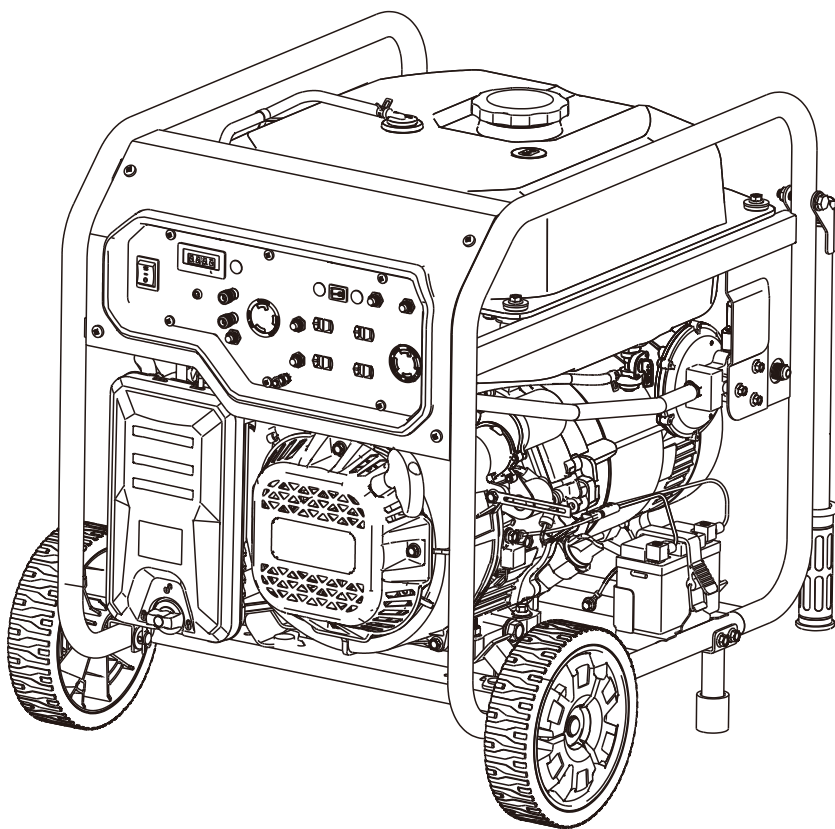

Model NO. PGL9000BCO

9000 WATT GENERATOR OPERATOR'S MANUAL



Warning: The Engine Exhaust from this product contains chemicals known to the State of California to cause cancer, birth defects or other reproductive harm.



DO NOT RETURN TO STORE!

HAVE QUESTIONS OR NEED SERVICE?



866-591-8921



support@pulsar-products.com

Table of Contents

Table of Contents	1
Instructions.....	1
Safety Warnings and Notices	1
Safety Instructions.....	2
Control Panel.....	6
Warning Labels.....	6
Assembly.....	7
Safety Mandates.....	10
General Safety - Best Practices	11
Add Gasoline.....	12
Connecting Propane	12

Fuel Selection	13
Engine Start - Electric	14
Engine Start - Recoil(Pull).....	15
Using Electrical Power	16
Generator Shutdown	17
Long Term Storage	18
Specifications	19
Component Locator -PGL9000BCO	20
Electrical Schematic.....	21

Introduction

Thank you for choosing Pulsar Products!

This manual provides instruction on how to operate and use your generator safely and correctly; be sure to read and understand this manual before using your generator. If you have ANY questions, please phone 866.591.8921 M-F or support@pulsar-products.com BEFORE using your generator.

All details and images in this User's Manual are believed to be accurate at the time of publication.

Pulsar Products reserves the right to make updates to this manual at any time.

Please contact Pulsar Support at **866.591.8921** or **support@pulsar-products.com** for the latest updates.

This manual is a permanent part of the generator set. If the generator is resold, kindly include this manual with the generator.

Safety Warnings and Notices

WARNING: Save This Manual For Future Reference

This manual contains important information regarding the safety, operation, maintenance, and storage of this product. Before use, read carefully and understand all cautions, warnings, instructions, and product labels. Failure to do so could result in serious personal injury and/or property damage.

Safety Definitions

The words DANGER, WARNING, CAUTION and NOTICE are used throughout this manual to highlight important information. Make sure that the meaning of this safety information is known to all who operate, perform maintenance on, or are near the generator.

 This safety alert symbol appears with most safety statements. It means to pay attention and be alert, your safety is involved! Please read and abide by the message that follows the safety alerts symbol.

DANGER

DANGER indicates an imminently hazardous situation which, if not avoided, will result in death or serious injury.

WARNING

WARNING indicates a potentially hazardous situation which, if not avoided, could result in death or serious injury.

CAUTION

CAUTION indicates a potentially hazardous situation which, if not avoided, may result in minor or moderate injury. It may also be used to alert against unsafe practices.

NOTICE

Failure to follow the instruction may result in the damage to your generator and other property

Safety Definitions

Follow all safety information contained in this manual and on the Warning Labels.

Safety Instructions

Before operating your generator, you must read and understand the manual and familiarize yourself with the safe operation practices.

SYMBOL	DESCRIPTION
	Safety Alert Symbol
	Electrocution Hazard
	Asphyxiation Hazard
	Burn Hazard. DO NOT touch hot surfaces
	Electrical Shock Hazard
	Fire Hazard
	Maintain Safe Distance
	Lifting Hazard
	Read Manufacturer's Instructions
	DO NOT Operate in Wet Conditions
	Ground. Consult with electrician to determine grounding requirements before use

Safety Precautions

DANGER

Using an engine indoors CAN KILL YOU IN MINUTES. Generator exhaust contains carbon monoxide. This is a poison you cannot see or smell.



NEVER use inside a home or garage, EVEN IF doors and windows are open.



ONLY use OUTSIDE and far away from windows, doors, and vents.

WARNING

POISONOUS GAS HAZARD: Engine exhaust contains carbon monoxide, a poisonous gas that could kill you in minutes. You CAN NOT smell it, see it, or taste it. Even if you do not smell exhaust fumes, you could still be exposed to carbon monoxide gas.

Operate this product **ONLY** outside far away from windows, doors and vents to reduce the risk of carbon monoxide gas from accumulating and potentially being drawn towards occupied spaces.

Install battery-operated carbon monoxide alarms or plug-in carbon monoxide alarms with battery backup according to the manufacturer's instructions. Most smoke alarms cannot detect carbon monoxide gas.

DO NOT run this product inside homes, garages, basements, crawlspaces, sheds, or other partially enclosed spaces even if using fans or opening doors and windows for ventilation. Carbon monoxide can quickly build up in these spaces and can linger for hours, even after this product has shut off.

ALWAYS place this product downwind and point the engine exhaust away from occupied spaces. If you start to feel sick, dizzy, or weak while using this product, shut it off and get to fresh air **IMMEDIATELY** - then see a doctor; you may have carbon monoxide poisoning.

Safety Instructions

Correct Usage

Example location to reduce risk of carbon monoxide poisoning

- **ONLY** use outside and downwind, far away from windows, doors, and vents.
- Direct exhaust away from occupied spaces.



Incorrect Usage

Do not operate in any of the following locations:

- Near any door, window, or vent
- Garage
- Basement
- Crawl Space
- Living Area
- Attic
- Entry Way
- Porch
- Mud Room

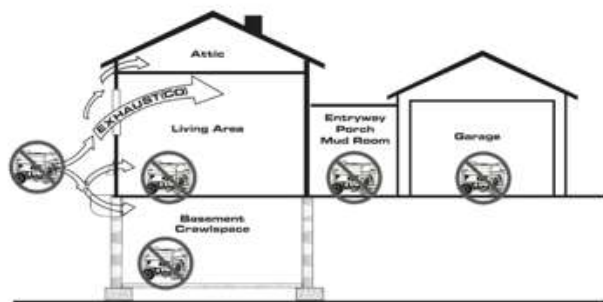

WARNING

Starter cord kickback (rapid retraction) will can hand and arm toward the engine faster than you can let go which could cause broken bones, fractures, bruises, sprains, or other serious injuries.

WARNING



Fuel and its vapors are extremely flammable and explosive which could cause burns, fire, or explosion resulting in death or serious injury and/or property damage.

When Adding or Draining Gasoline

Turn the generator engine OFF and let it cool for at least 2 minutes before removing the fuel cap. Loosen the cap slowly to relieve pressure in the tank.

- Fill or drain fuel tank outdoors.
- **DO NOT** overfill the tank. Allow space for fuel expansion.
- If fuel spills, wipe it up and let the area dry before starting the engine.
- Keep fuel away from sparks, open flames, heat, and other ignition sources.
- Check fuel lines, tank, cap, and fittings frequently for cracks or leaks; replace if necessary.
- **DO NOT** light a cigarette or smoke anything.

When Starting Equipment

- Ensure spark plug, muffler, fuel cap, and air cleaner are in place.
- **DO NOT** crank engine with spark plug removed.

When Operating Equipment

- **DO NOT** operate this product inside any building, carport, porch, mobile enclosure, marine applications, or shed.
- **DO NOT** tip engine or equipment at an angle that causes fuel to spill.
- **DO NOT** stop the engine by moving the choke control the to "Start" position.
- **DO NOT** exceed the generator's wattage capacity.
- Start the generator and the let engine stabilize before connecting electrical loads.
- Connect electrical loads in the OFF position, then turn ON for operation.
- Turn electrical loads OFF and disconnect from the generator before stopping the generator.

Safety Instructions

NOTE

Improper treatment of the generator could damage it and shorten its life.

- Use generator only for intended applications.
- If you have questions about intended use, ask a dealer or contact your local Pulsar service center.
- Operate generator only on solid, level surfaces.
- DO NOT expose the generator to excessive moisture, dust, dirt, or corrosive vapors.
- DO NOT insert any objects through cooling slots.
- If connected devices overheat, turn them off and disconnect them from the generator.

Shut off the generator if:

- Electrical output is lost.
- Equipment sparks, smokes, or emits flames.
- Unit vibrates excessively.

Parallel Kit Precautions

⚠ WARNING

To prevent serious injury, death, and generator and/or equipment damage from electric shock and fire:

1. Follow Parallel Kit instructions provided with it for connection and use of a Parallel Kit.
2. Only connect two identical Inverter Generators together using a Parallel Kit.
3. Connect Parallel Kit only to terminals marked "Parallel" on the front of the Generator.
4. Do not remove or connect a Parallel Kit while the Generator is running.
5. Do not use a Parallel Kit that is attached to only one Generator.

Carbon Monoxide Safety

Carbon Monoxide

Generators are very convenient, but they can also be very dangerous. All fuel-burning appliances and equipment release a poisonous gas called carbon monoxide. Carbon monoxide (also known as CO) can be dangerous for humans and pets, even in small amounts, because it blocks oxygen from getting into your body. Carbon monoxide poisoning can lead to death in a very short time. It is odorless, tasteless and invisible, so you may be exposed without knowing it. That is why carbon monoxide is sometimes called "the silent killer."

The CO protect module monitors for the accumulation of poisonous CO gas found in engine exhaust when the generator is running. If CO protect detects increasing levels of CO gas, it automatically shuts off the engine.

After an automatic shut-off, a red light will blink, notifying the user that the generator was shut-off due to excessive CO accumulation. The RED light will blink for at least five minutes after a CO shut-off. Immediately, move the generator to an open, outdoor area and point the exhaust away from people and occupied buildings.

If a CO protect system fault has occurred the generator will shut off automatically and the YELLOW light will blink for five minutes in the CO protect badge, informing the user of the fault. If this happens, please consult an authorized Pulsar Products Service Center.

CO Protect Label

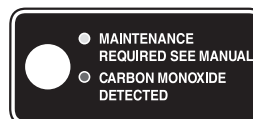
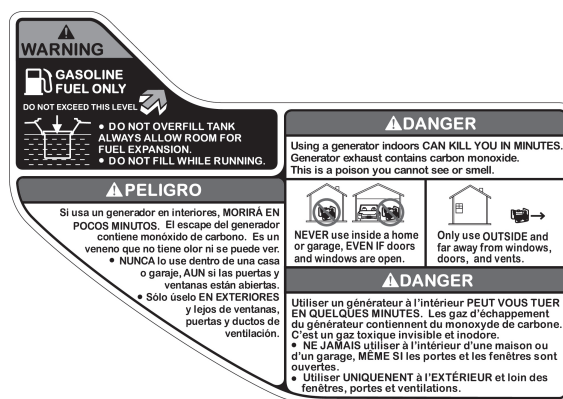

Safety Instructions

Button/Coin Battery Safety

⚠ WARNING	
<ul style="list-style-type: none">• INGESTION HAZARD: This product contains a button cell or coin battery.• DEATH or serious injury can occur if ingested.• A swallowed button cell or coin battery can cause Internal Chemical Burns in as little as 2 hours.• KEEP new and used batteries OUT OF REACH OF CHILDREN• Seek immediate medical attention if a battery is suspected to be swallowed or inserted inside any part of the body.	



This symbol means:

INGESTION HAZARD: This product contains a button cell or coin battery.

1. Remove and immediately recycle or dispose of used batteries according to local regulations and keep away from children. Do NOT dispose of batteries in household trash or incinerate.
2. Even used batteries may cause severe injury or death.
3. Call a local poison control center for treatment information.
4. The voltage of battery CR2032 is usually 3V or 3.1V, for more information, please check the generator manual or dealer.
5. Non-rechargeable batteries are not to be recharged.
6. Do not force discharge, recharge, disassemble, heat above 60 °C (140 °F) or incinerate. Doing so may result in injury due to venting, leakage or explosion resulting in chemical burns.

NOTE: THIS PRODUCT CONTAINS NON-REPLACEABLE BATTERIES

Control Panel

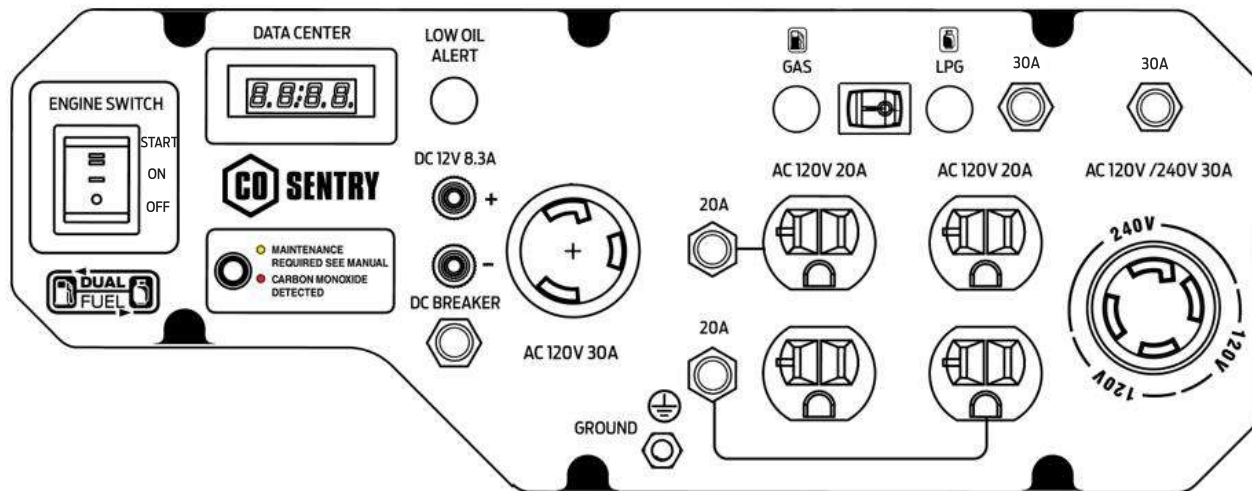

Warning Labels

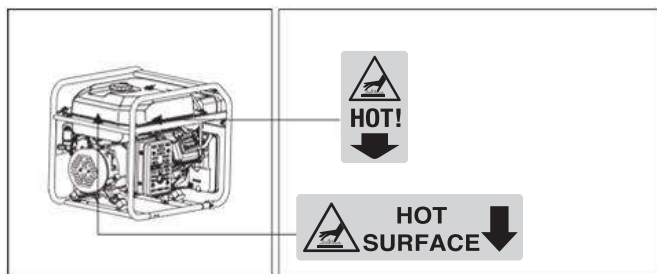
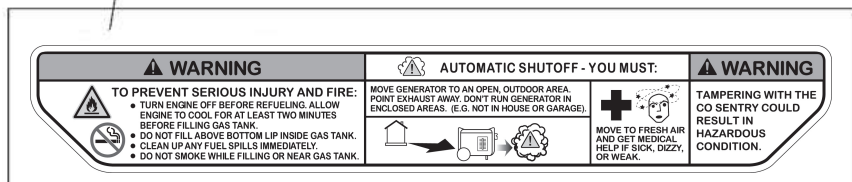
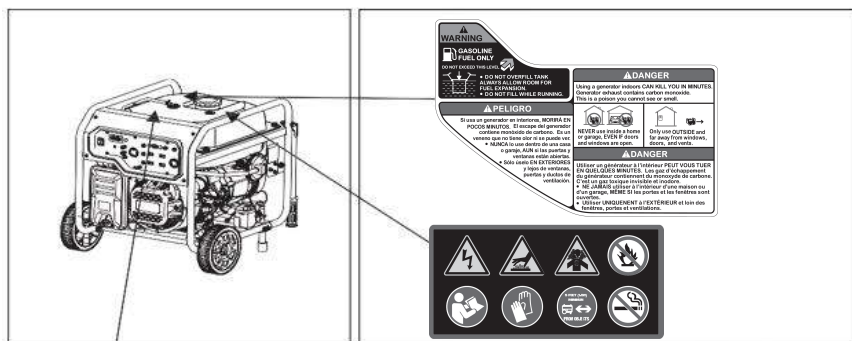

Assembly

⚠ WARNING

Weight hazard. Always have assistance when lifting the generator. Never attempt to lift the unit by the handle. Hold the unit by the frame and use proper lifting techniques to reduce the risk of back injury.

This product requires assembly. Do not attempt to operate this product if any items in the Assembly Parts List are already assembled when you remove the carton contents. These items are not assembled by the manufacturer and should require customer assembly. Using an improperly assembled product can be hazardous and could result in serious personal injury.

- Carefully cut down the sides of the packaging and remove the carton contents.
- Inspect the carton contents. Verify that all the items in the Assembly Parts List are present and undamaged.
- Recycle or dispose of the packaging materials properly.

Assembly Parts List

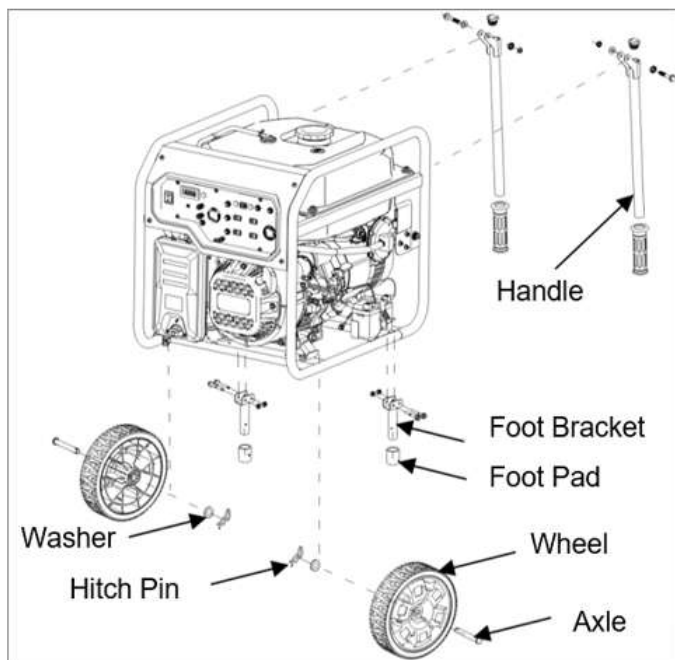

Required Tools

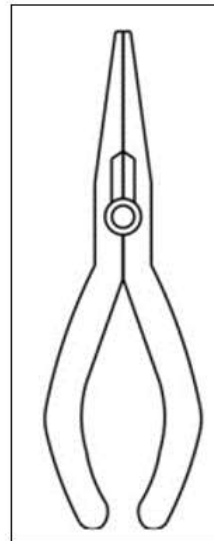

Narrow Nose Pliers

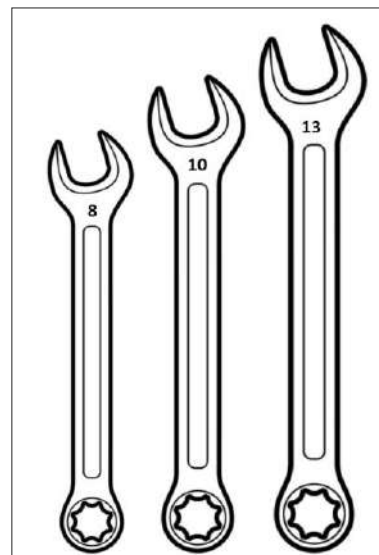

8, 10mm, 13mm open wrenches

Assembly

⚠ CAUTION

Do not alter or modify this product unless instructed to so in this manual or by the manufacturer. Do not use attachments or accessories that are not recommended for use with this product. Making unauthorized modifications and using incompatible accessories can damage the unit and void your warranty.

Installing Support Leg

- Parts needed - Support leg & M6 screw (2) and 2 nuts.



M6x40 Bolts x4
Used for
Support Leg



M6 Nut x4
Used for Support
Leg

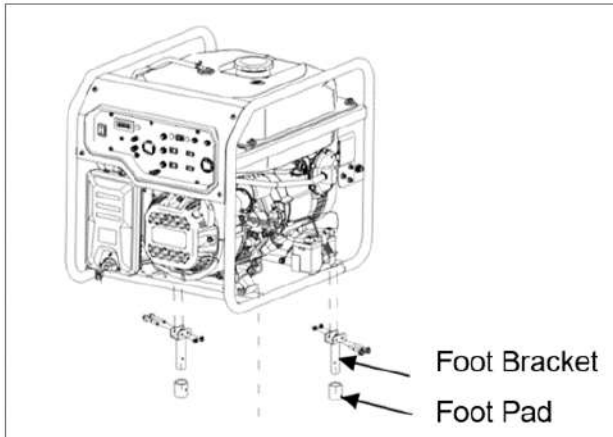

- Line up holes on the support leg bracket to the holes on the front of the generator frame.
- Attach the support leg using M6 screws (2) and nuts.

Attaching Wheels

- Parts needed - 2 wheels, 2 axles, 2 hitch pins, and 2 washers.
- Raise or tilt generator so you can slide the wheel axle pin into the wheel, the washer, the wheel mounting hole located on the side of the frame.

Attaching Wheels (cont.)

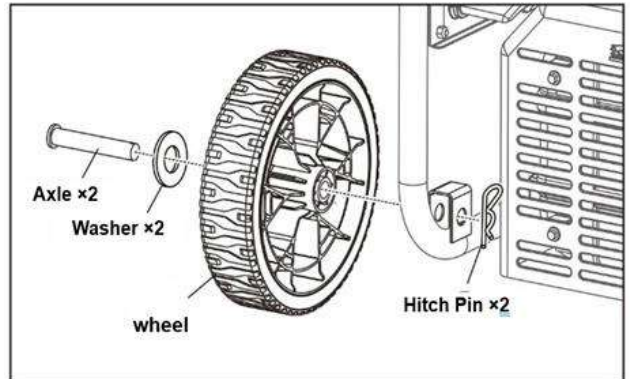

- Secure the wheel assembly by inserting a hitch pin through hole at the end of the wheel axle and pressing until it locks into place.
- Repeat process on the other side of the generator to install the second wheel.

Installing the Handle

⚠ CAUTION

Pinch point hazard. Do not place your hand or fingers between the handle and the generator's frame.

- Parts needed-Handle & M8 screw (2) and 2 nuts

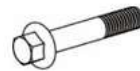

M8x45 Bolts x2
Used for Handle



M8 Nut x2
Used for Handle

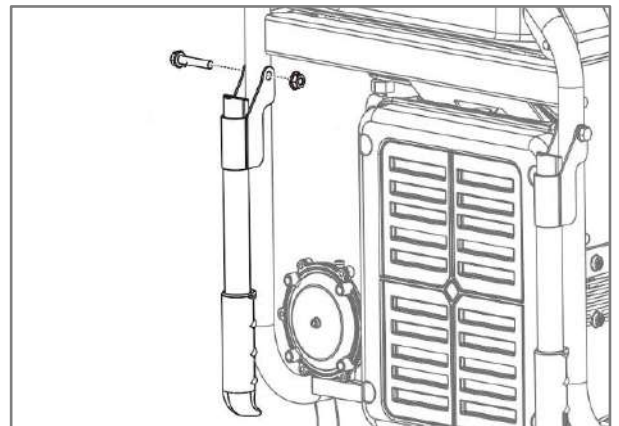

Assembly

Installing the Handle (cont.)

- Position the handle and bolts.
- Align the holes on the handle with the holes on the downtube.
- Thread the bolt through the hole on the handle and the hole on the downtube.
- Tighten nuts securely. Do not over tighten.
- Repeat these steps to install second handle.

Accessories Installation

Some models feature an Electric Start option, which require assembly of a battery bracket and band.

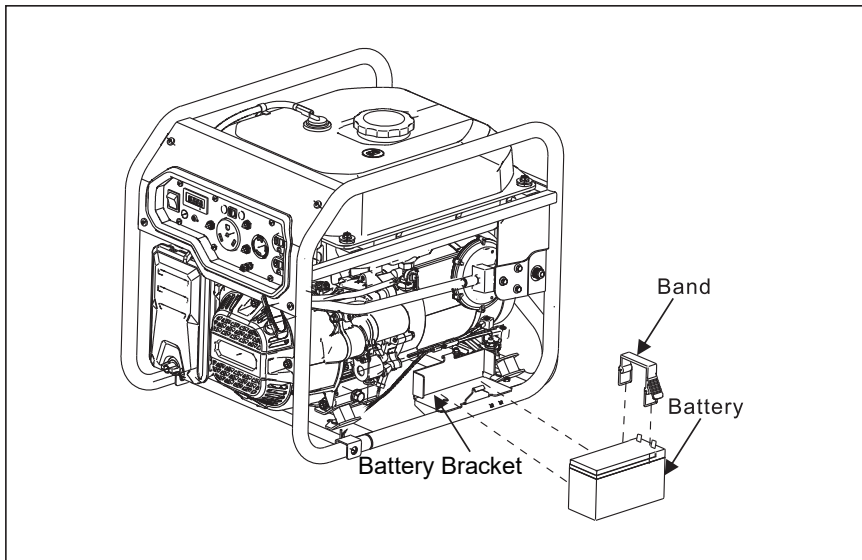

- 1 Install the positive terminal and negative terminal onto the generator unit as specified in the drawing.
- 2 Install the storage battery bracket onto the bracket connection tube.
- 3 Install the storage battery shield onto the bracket connection tube.
- 4 Install the assembled bracket onto the unit.
- 5 Put the storage battery into the bracket.
- 6 Hook the hook bolt to the hole of the bracket, and install it onto the storage battery clamp.
- 7 Tighten the bolt and install the storage battery onto the bracket.
- 8 Connect the storage battery wires and connect the negative one first. The connected terminals may be different as the models of the storage batteries are different. Take material object as.
- 9 Some storage batteries need to be filled with electrolyte before installation. Please read the specification of the storage battery carefully.

Safety Mandates



⚠ DANGER

NEVER use or store a generator indoors!



⚠ DANGER

Keep the generator clean and wipe up any spilled gasoline or oil at once.



⚠ WARNING

Never use in direct rain or wet conditions.

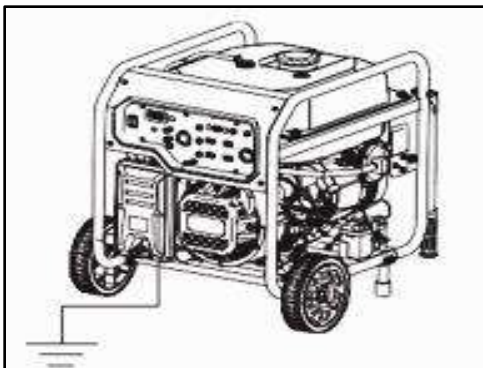

⚠ WARNING

Some applications may require external grounding. Check with a local, licensed electrician or phone Pulsar at 866.591.8921 for guidance.

General Safety – Best Practices

DANGER

This generator makes enough electrical power to cause serious shock or electrocution if misused.

Operator should wear personal protection suitable for the environment and task. Example: Heat resistant gloves, hearing protection and safety glasses when operating or maintaining the generator.

Do not attempt major repairs or internal work on the generator. Leave this job to a qualified repair shop or a Pulsar authorized service center.

Never operate any generator underground or in any kind of enclosed, explosive or IDLH (Immediately Dangerous to Life and Health) environment.

Never touch any exposed wires or operate any generator with wet hands.

Always keep children and pets away from any generator whether it is running or not.

Always use an inline GFCI (Ground Fault Circuit Interrupter) when connected loads operate in a damp location.

Never add fuel while the generator is running!

Immediately wipe up any spilled gasoline with a cloth rag or paper towel, but do NOT place it in a trash can until it is completely dry.

You **MUST** maintain a minimum distance of 6 feet (2 meters) between the generator and any structure or other flammable materials

Only dispose of oil or gasoline in accordance with your municipal recycling or waste management program, NEVER place it in the trash for collection!

Only dispose of oil or gasoline in accordance with your municipal recycling or waste management program, NEVER place it in the trash for collection!
Never place any heavy items on top of the generator.

Always shut down the generator and allow it to cool completely before attempting any adjustments, maintenance or repair.

DANGER

During operation this generator has many fast moving and rotating parts. Always contain long hair, loose jewelry and clothing before approaching a generator

DANGER

Never connect in series (Daisy Chain) electrical extension cords! You must consult a **Wire Gauge Calculator** to determine the appropriately sized cable cross-section for your specific use case, load profile, and run distance.

DANGER

Do NOT attempt to connect in parallel any different model of generator. Use only Pulsar approved parallel kits with generators that are certified to work together.

DANGER

ALWAYS remain aware of wind direction and take great care to point the generator exhaust flow AWAY from any structure or occupied space. Keeping a minimum distance of 6 feet from any flammable object is recommended

NOTICE

For maximum service life, do not run the generator in excess of it's rated output and always maintain the equipment per manufacturers recommendations.

NOTICE

The wheels and handles provided with the unit are for convenience of placement, never attempt to tow the generator or cover long distances with this equipment.

Adding Gasoline

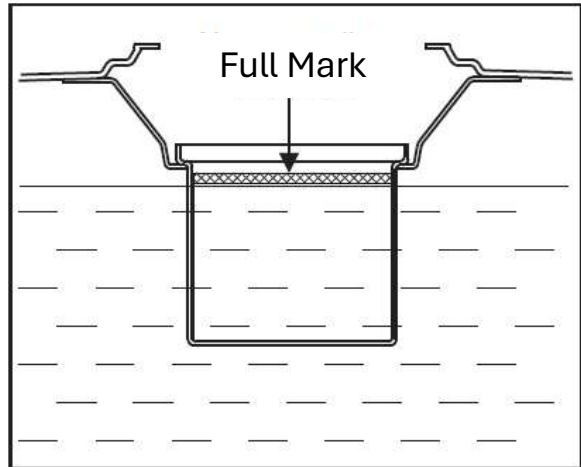
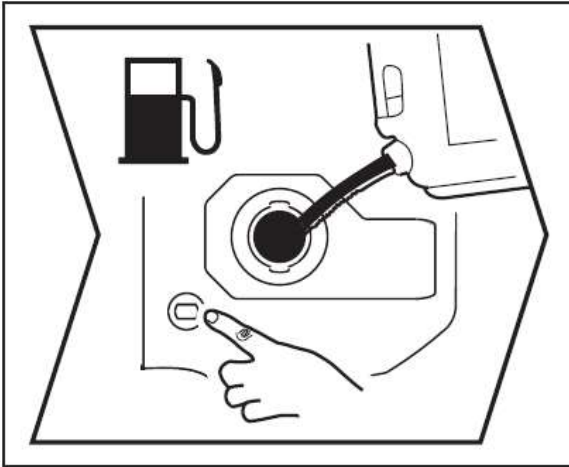

1. Never unscrew a fuel cap or attempt to refuel a running generator!
2. Unscrew and remove the fuel tank cap and set it aside.
3. Keep away all ignition sources and never smoke anything while fueling a generator!
4. Add FRESH GASOLINE ONLY to the fuel tank until it is filled to the desired level.
5. Do NOT fill gasoline beyond the Full Mark in the illustration above, right.
6. Note there is a float-type fuel gauge, for your convenience per illustration above, left.

Connecting Propane

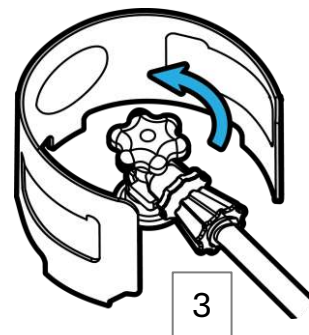
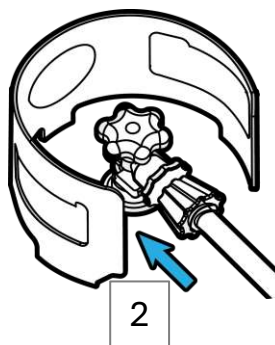
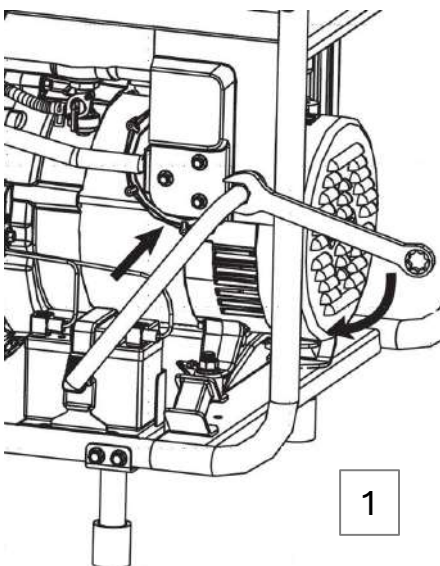

1. Thread propane supply hose onto the generator male fitting and snug it with a wrench. Do not overtighten!
2. Attach regulator hose to propane supply tighten by hand.
3. Open propane supply valve and check for leaks.

Fuel Selection

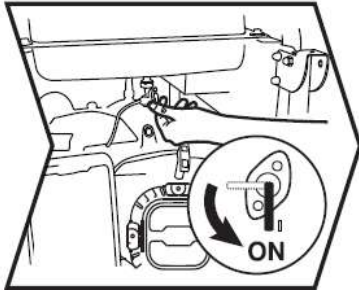

Gasoline Petcock

Move to 'ON' if you intend to run the generator on gasoline.

Keep the petcock closed if you intend to run the generator on propane.

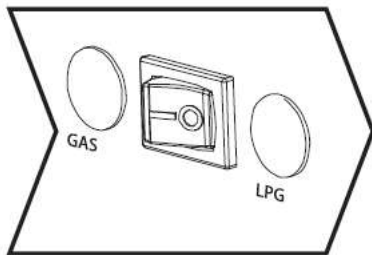

Fuel Selector Switch

Move this switch to your desired fuel source
GAS = Gasoline LPG - Propane.

Engine Start - Electric

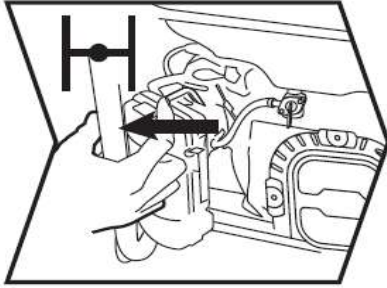

Choke Lever

Cold Engine – Move the lever left for starting.

Warm Engine – Partial choke for starting.

Running Engine – Move the lever full right.

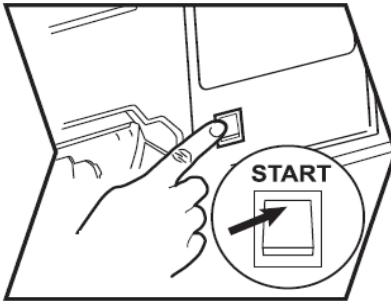

Engine Switch

Press and hold the engine switch in the START position to crank the engine for a few seconds, or until the engine starts, then release the switch.

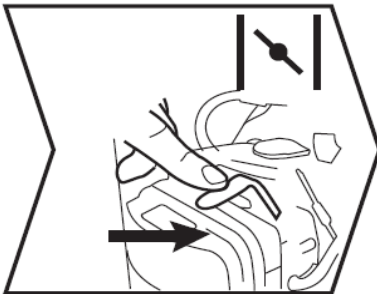

Open the Choke

After a successful engine start, gradually open the choke by moving the choke lever to the right until it is fully open. You may need to do this slowly in very cold weather.

Engine Start – Recoil (Pull)

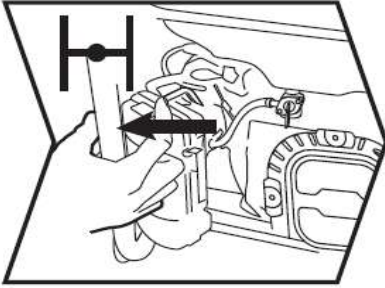

Choke Lever

Cold Engine – Move the lever left for starting.

Warm Engine – Partial choke for starting.

Running Engine – Move the lever full right.

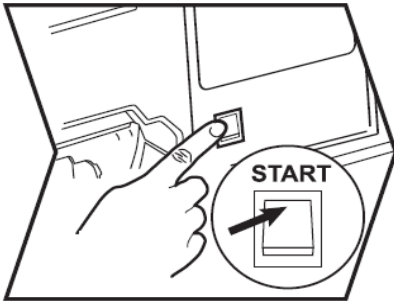

Engine Switch

Move the engine switch to the 'ON' position.

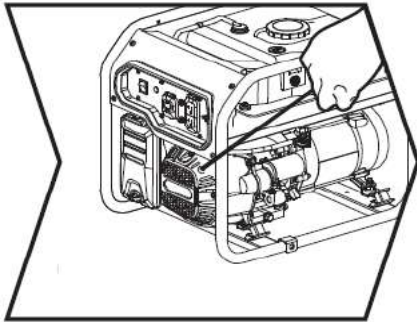

Recoil Start

With a firm, stable footing, grasp the recoil handle and pull it out until resistance is felt. Let the rope retract, then pull it swiftly and fully. Repeat this step as necessary until the engine starts.

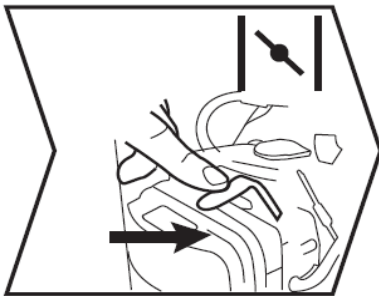

Open the Choke

After a successful engine start, gradually open the choke by moving the choke lever to the right until it is fully open. You may need to do this slowly in very cold weather.

Using Electrical Power

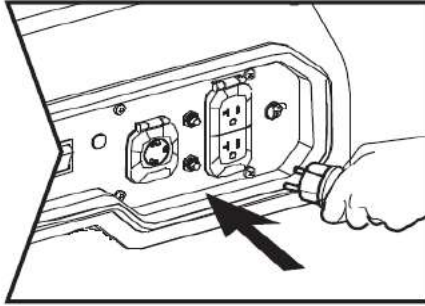

Connect Load(s)

Allow the engine to warm up for at least 30 seconds, then attach your loads from smallest to largest, allowing the generator to stabilize between each load applied.

Take care not to exceed the load limits of the generator, especially with **inductive loads** such as motors.

Power output is based upon sea level, +15C, and 30% RH. Changes in elevation and weather can reduce the generator capacity.

Generator Shutdown

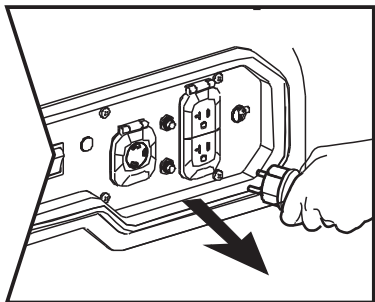

Remove Loads

Switch off then unplug all connected devices.

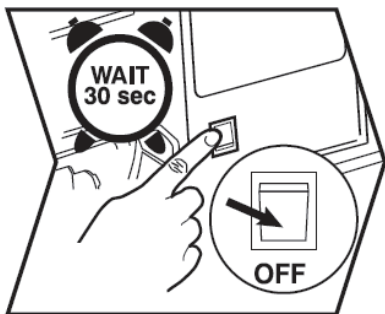

To Store the Generator <30 days

Remove all loads, wait 30 seconds, then move the Engine Switch to 'OFF'.

To Store the Generator >30 days

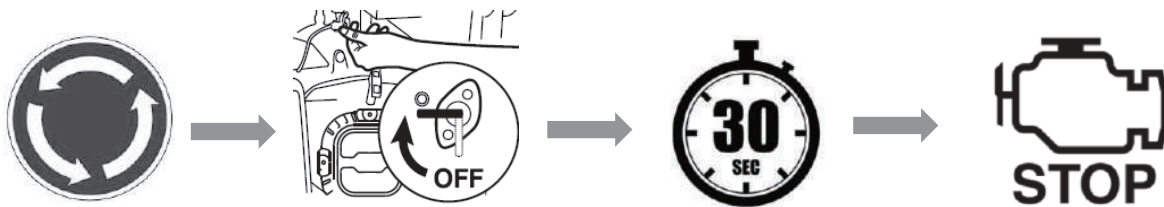

Engine running Close the petcock Fuel is consumed Engine stop

Long Term Storage

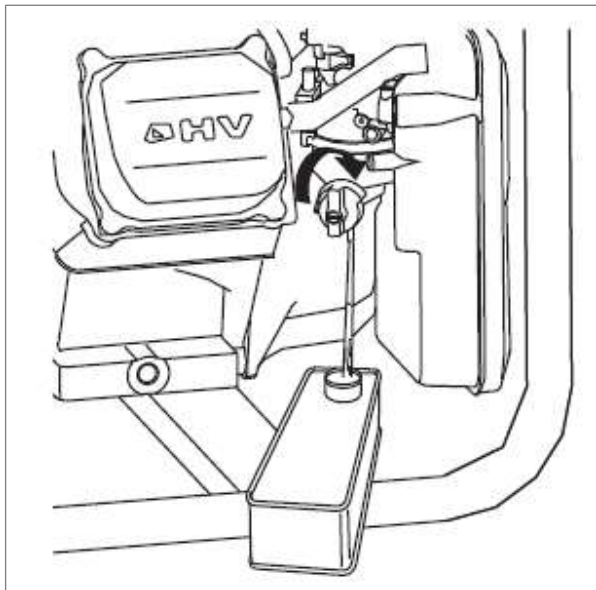

Drain the Gasoline

With the gasoline petcock OFF you may place a suitable container under the carburetor, remove the drain plug and collect remaining gasoline from the float bowl.

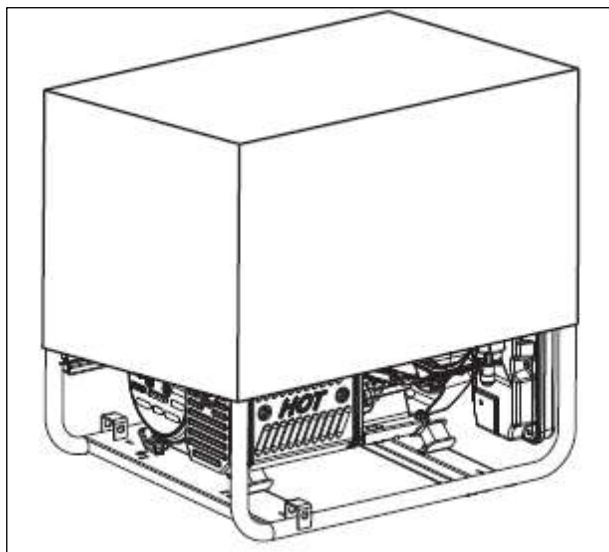

Elemental Protection

For long term storage a suitable weather protective cover should be used to protect your generator from rain, dirt, and debris.

Specifications

Model	PGL9000BCO
AC output	
Frequency	60Hz
Voltage	120V/240V
Rated Power (GAS/LPG)	7.2/6.5 kW
Peak Power (GAS/LPG)	9.0/8.1 kW
Engine	
Type	Single cylinder, forced air cooling, 4 strokes
RPM	3600 r/min
Fuel	Gasoline / LPG
Capacity of fuel tank	7 gallons
Engine oil capacity	0.9 L
Spark plug type	F7TC/F7RTC (N9YC /RN9YC)
Spark Plug Gap	0.7-0.8 mm
Valve clearance (Intake/Exhaust)	0.05-0.10 mm / 0.10-0.15mm
Igniting Mode	T.C.I.
Starting mode	Recoil start / Electric start
Displacement	340cc
Weight (only for reference)	
Net weight(kg)	134 lbs. (Recoil start) / 143 lbs. (Electric start)
Overall dimensions (excluding packing box)	
L x W x H (mm)	24.5x19.5x22 inches

Component Locator –PGL9000BCO

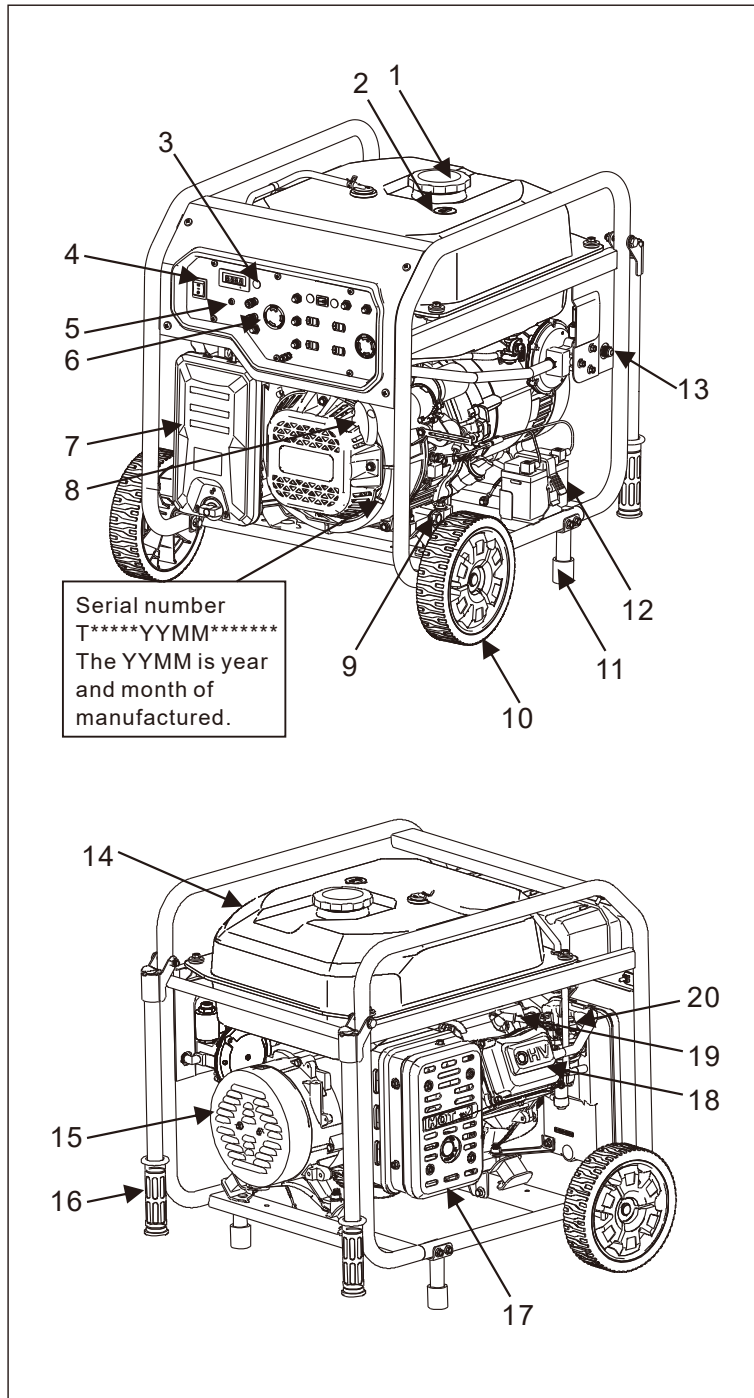

Recoil start

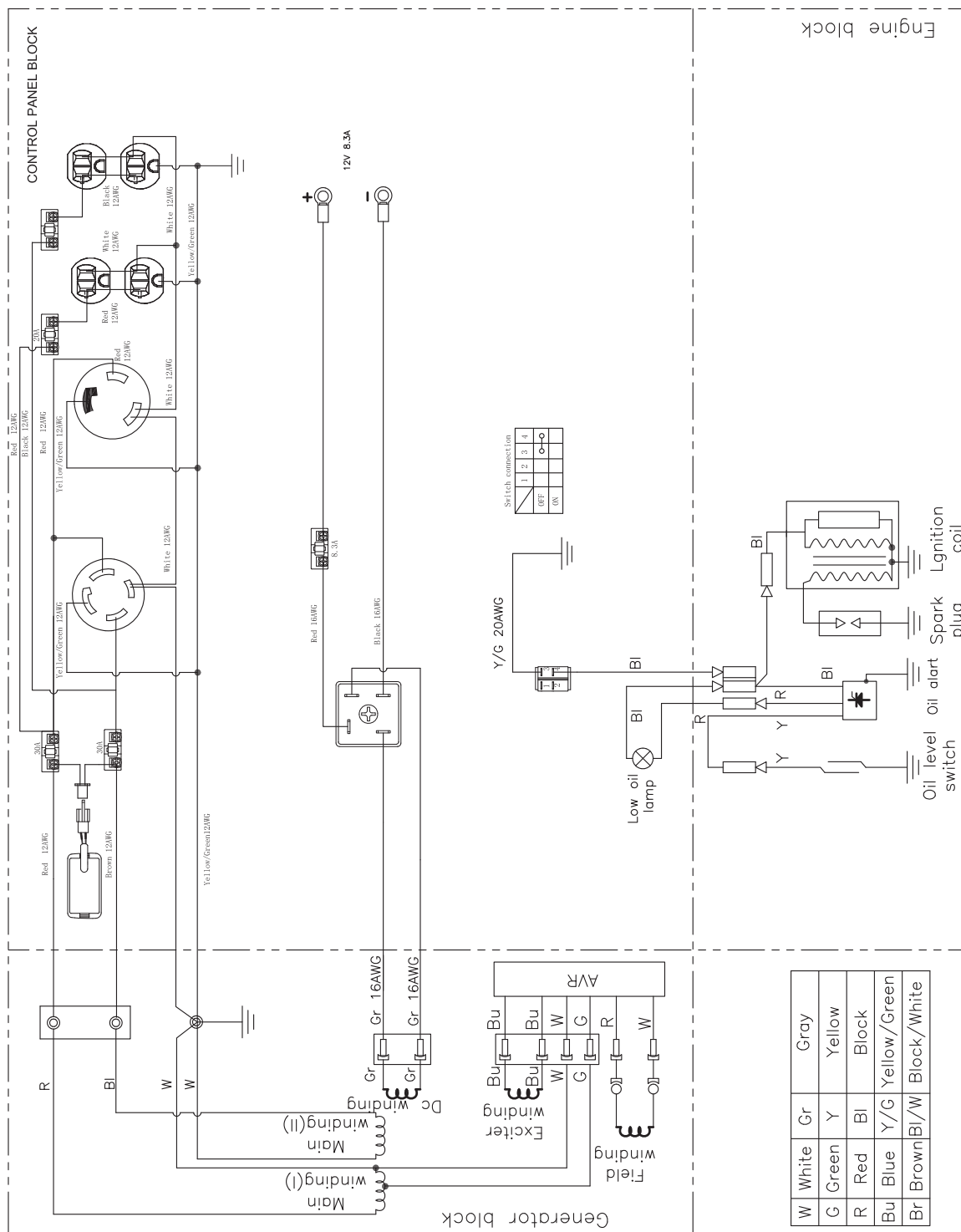

Electric start

